

THIS PLAT IS NOT A SUBDIVISION AS DEFINED BY THE GREENVILLE COUNTY SUBDIVISION REGULATIONS.
 L. 12, 1985 *John H. Williams Jr.*
 Chairman, Secretary, or Director of Planning.
 Greenville County Planning Commission

FILED
 GREENVILLE CO. S.C.
 JAN 7 4 37 PM '85
 DONNIE S. TANKERSLEY
 R.M.C.

PAT HARTNESS

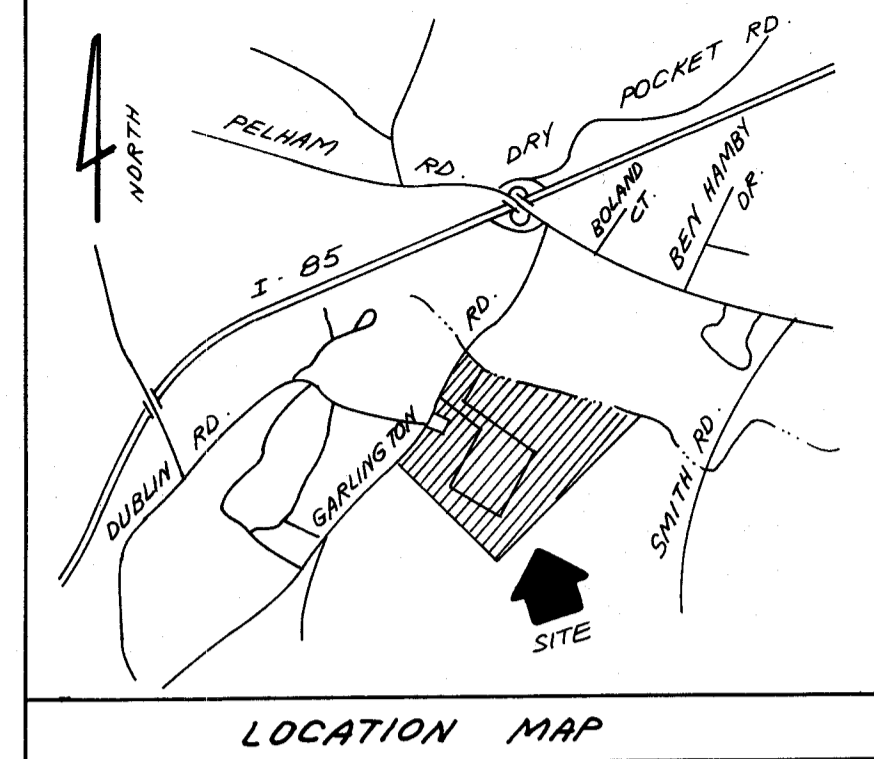

ROLLING GREEN VILLAGE

MAG
 JAN 7 1985
 10Z-91 ✓

REV. DEC. 3, 1984
 REV. SEPT. 26, 1984
 REV. SEPT. 24, 1984

I hereby certify that the ratio of precision of the field survey is 1/5,000 as shown hereon and the area was determined by DMD Method.

James R. Freeland
 James R. Freeland RLS & PE 4781

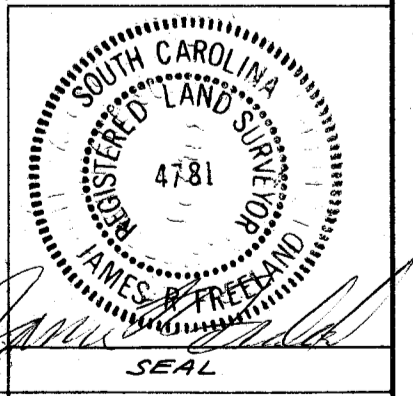

STATE OF SOUTH CAROLINA GREENVILLE COUNTY		FREELAND & ASSOCIATES Engineers & Land Surveyors GREENVILLE, S.C.	
SURVEY FOR HARTNESS INTERNATIONAL		SURVEY <i>R.S.</i>	
SCALE 1" = 200		DRAWN <i>K.E.G.</i>	
DATE <i>SEPT 19, 1984</i>		CHECK	
DWG. NO. 11791-1		SCALE 1" = 200	
SCTD -- 3 JA 7 85		DATE <i>SEPT 19, 1984</i>	
		DWG. NO. 11791-1	



THE PRINT MACHINE, INC. N4837

RECORDED